



Alacrity Solutions Commercial Services Division

9725 Windermere Drive
Fishers, IN 46037

Insured: City of Oberlin
Property: 12-35-29W
Oberlin, KS 67749

Claim Rep.: Kelly Kaiser
Business: 245 N. Waco Ste. 330
Wichita, KS 67202

Business: (316) 352-5832
E-mail: kelly.j.kaiser@emcins.com

Estimator: Scott Bradley

Business: (314) 803-6341
E-mail: scott.
bradley@alacritysolutions.
com

Claim Number: 1730956

Policy Number: 6A3-07-02---23

Type of Loss: Hail

Date of Loss: 6/7/2022 7:15 PM
Date Inspected:

Date Received: 6/10/2022 7:15 PM
Date Entered: 6/12/2022 7:13 PM

Price List: KSKS8X_JUN22
Restoration/Service/Remodel
Estimate: OBERLIN-LOC17-BLDG-1

This is an estimate of observed damage only. This is not an authorization of repair, nor is it a guarantee of payment. Your policy may contain provisions that could change the amount. The Insurer assumes no responsibility for any repair performance.



Alacrity Solutions Commercial Services Division

9725 Windermere Drive
Fishers, IN 46037

OBERLIN-LOC17-BLDG-1

General Items

QUANTITY	TAX	RCV	AGE/LIFE	COND.	DEP %	DEPREC.	ACV
----------	-----	-----	----------	-------	-------	---------	-----

Totals: General Items

Main Level

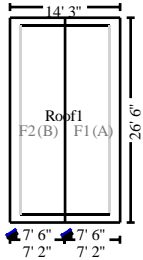

Roof1

398.05 Surface Area	3.98 Number of Squares
83.04 Total Perimeter Length	26.50 Total Ridge Length

QUANTITY	TAX	RCV	AGE/LIFE	COND.	DEP %	DEPREC.	ACV
2. Remove Roof vent - turbine type - Standard grade							
1.00 EA							
5. Roof vent - turbine type - Standard grade							
1.00 EA							
19. Tear off, haul and dispose of comp. shingles - Laminated							
3.98 SQ							
20. Remove Drip edge							
83.04 LF							
21. Roofing felt - 15 lb.							
3.98 SQ							
22. Drip edge							
83.04 LF							
23. Asphalt starter - universal starter course							
53.00 LF							
24. Laminated - comp. shingle rfg. - w/out felt							
4.67 SQ							
25. Ridge cap - composition shingles							
26.50 LF							
26. Digital satellite system - Detach & reset							
1.00 EA							

Totals: Roof1

Total: Main Level



Alacrity Solutions Commercial Services Division

9725 Windermere Drive
Fishers, IN 46037

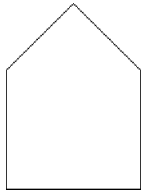

Rear Elevation (West)

Formula Elevation 24' 4" x 8' 1" x 0"

196.69 SF Walls
196.69 SF Long Wall
24.33 LF Ceil. Perimeter

24.33 LF Floor Perimeter
196.69 SF Short Wall

QUANTITY	TAX	RCV	AGE/LIFE	COND.	DEP %	DEPREC.	ACV
10. Remove Fascia - metal - 6" 26.50 LF							
11. Fascia - metal - 6" 26.50 LF							
12. Remove Wall/roof panel - ribbed - 26 gauge - up to 1" 196.69 SF							
14. Wall/roof panel - ribbed - 26 gauge - up to 1" 196.69 SF							
27. Remove Metal J trim 9.00 LF							
28. Metal J trim 9.00 LF							

Totals: Rear Elevation (West)

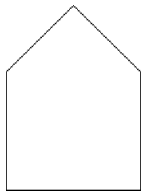

Right Elevation (North)

Formula Elevation 12' 3" x 8' 1" x 2'

111.27 SF Walls
111.27 SF Long Wall
12.89 LF Ceil. Perimeter

12.25 LF Floor Perimeter
111.27 SF Short Wall

QUANTITY	TAX	RCV	AGE/LIFE	COND.	DEP %	DEPREC.	ACV
6. Remove Fascia - metal - 6" 15.00 LF							
9. Fascia - metal - 6" 15.00 LF							
15. Remove Wall/roof panel - ribbed - 26 gauge - up to 1" 111.27 SF							
16. Wall/roof panel - ribbed - 26 gauge - up to 1" 111.27 SF							
17. Remove Attic vent - gable end - metal - 12" x 18" 1.00 EA							



Alacrity Solutions Commercial Services Division

9725 Windermere Drive
Fishers, IN 46037

CONTINUED - Right Elevation (North)

QUANTITY	TAX	RCV	AGE/LIFE	COND.	DEP %	DEPREC.	ACV
18. Attic vent - gable end - metal - 12" x 18"							
1.00 EA							

Totals: Right Elevation (North)

Line Item Totals: OBERLIN-LOC17-
BLDG-1

Grand Total Areas:

307.97 SF Walls	0.00 SF Ceiling	307.97 SF Walls and Ceiling
0.00 SF Floor	0.00 SY Flooring	36.58 LF Floor Perimeter
307.97 SF Long Wall	307.97 SF Short Wall	37.22 LF Ceil. Perimeter
0.00 Floor Area	0.00 Total Area	0.00 Interior Wall Area
22.36 Exterior Wall Area	0.00 Exterior Perimeter of Walls	
398.05 Surface Area	3.98 Number of Squares	83.04 Total Perimeter Length
26.50 Total Ridge Length	0.00 Total Hip Length	